

Remote Monitoring & Maintenance program

The power of prediction; the power of remote

Next-Turbo's Remote Monitoring & Maintenance packages enables remote access and data collection – two requisits of predictive maintenance.

Plant owners and operators often track basic operational log-data of the turbo-compressors in their central system, but lack the depth & longterm aspects of data collection. As well as the expert algorithms to determine valuable predictions of the health of the installation.

Next-Turbo feels responsible for our turbocompressors, over its entire lifetime. We strive to bridge the gap in data collection towards a truly predictive maintenance with our Remote upgrade packages.

The equipment owner has full visibility over its log-data via our secure **'My NTT Equipment'** internet portal.

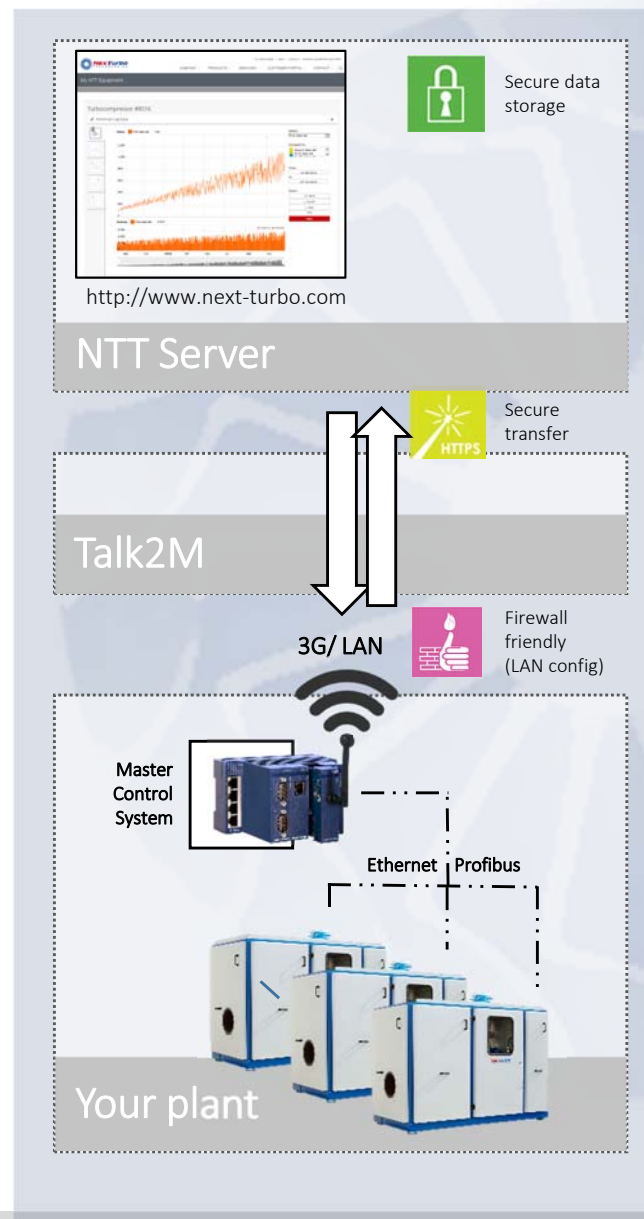

Register your turbocompressor now at:

<http://www.next-turbo.com/register>

If you are interested in Remote Monitoring & Maintenance and would like to have more informations, contact us or go to our web-pages. If you already have purchased a Next Turbo Turbocompressor, register at our internet portal and select a remote monitoring & maintenance package to get started.



Available Packages

Remote Access package

Our technical experts can connect via secured LAN or 3G mobil network to the Master Control, Local Control and HMI Systems (MCS/ LCP). It enables us to troubleshoot, change/ upgrade software and perform remote services on the machine.

Remote Monitoring packages

Instrument data is logged in realtime onto the installed modem and transfered in regular intervals to our remote NTT secure server for storage and analysis.

Predictive Maintenance packages

The data collected via Remote Monitoring is being analysed statistically and via deep-learning algorithms to derive a status of the health and remaining lifetime of crucial parts. A regular report with service/ upgrade recommendations is being made available.

All historical instrument data collected in NTT servers are available for viewing and own analysis in our **'My NTT Equipment' internet portal**. Remote access history, as well as all project documentation and service reports are available online.

		Packages				
		Intro	Data 1	Data 2	Predictive 1	Predictive 2
		Remote Access	Remote Monitoring BASIC	Remote Monitoring EXPERT	Predictive Maintenance BASIC	Predictive Maintenance EXPERT
Functions included in Package	Remote Access	●	●	●	●	●
	Local Data-/ Alarm Logging limited to 1 million data points locally	---	●	●	●	●
	Remote Data-/ Alarm Logging unlimited storage on NTT servers	---	---	●	●	●
	Data Access via NTT Equipment Portal	---	---	●	●	●
	Transfer/ access method LAN/ Wireless LAN	●	---	●	●	●
	3G Mobil Data	(●)	---	(●)	(●)	●
	Alarm notification SMS/Email	---	---	---	---	●
	Expert telephone hotline					
	Office hour support	Optional				
	24/7 support	Optional				